

ST. TAMMANY PARISH COUNCIL

ORDINANCE

ORDINANCE CALENDAR NO: 4626

ORDINANCE COUNCIL SERIES NO: _____

COUNCIL SPONSOR: GOULD/DAVIS

PROVIDED BY: PLANNING

INTRODUCED BY: BURKHALTER

SECONDED BY: CANULETTE

ON THE 4 DAY OF AUGUST, 2011

AN ORDINANCE AMENDING THE OFFICIAL ZONING MAP OF ST. TAMMANY PARISH, LA, TO RECLASSIFY A CERTAIN PARCEL LOCATED ON THE SOUTHWEST CORNER OF US HIGHWAY 11 & FRICKE ROAD AND WHICH PROPERTY COMPRISES A TOTAL 0.75 ACRE OF LAND MORE OR LESS, FROM ITS PRESENT HC-3 (HIGHWAY COMMERCIAL DISTRICT) TO AN I-1 (INDUSTRIAL DISTRICT). (WARD 8, DISTRICT 14) (ZC11-06-057)

WHEREAS, the Zoning Commission of the Parish of St. Tammany after hearing in accordance with law, Case No. ZC11-06-057, has recommended Denial to the Council of the Parish of St. Tammany, Louisiana, that the zoning classification of the above referenced area remains HC-3 (Highway Commercial District); and

WHEREAS, the St. Tammany Parish Council has held its public hearing in accordance with law; and

WHEREAS, the St. Tammany Parish Council has found it necessary for the purpose of protecting the public health, safety and general welfare, to designate the above described property as I-1 (Industrial District).

THE PARISH OF ST. TAMMANY HEREBY ORDAINS, in regular session convened that:

SECTION I: The zoning classification of the above described property is hereby changed from its present HC-3 (Highway Commercial District) to an I-1 (Industrial District) see Exhibit "A" for complete boundaries.

SECTION II: The official zoning map of the Parish of St. Tammany shall be and is hereby amended to incorporate the zoning reclassification specified in Section I hereof.

REPEAL: All ordinances or parts of Ordinances in conflict herewith are hereby repealed.

SEVERABILITY: If any provision of this Ordinance shall be held to be invalid, such invalidity shall not affect other provisions herein which can be given effect without the invalid provision and to this end the provisions of this Ordinance are hereby declared to be severable.

EFFECTIVE DATE: This Ordinance shall become effective fifteen (15) days after adoption.

[REMAINDER OF PAGE INTENTIONALLY LEFT BLANK]

MOVED FOR ADOPTION BY: _____ SECONDED BY: _____

WHEREUPON THIS ORDINANCE WAS SUBMITTED TO A VOTE AND RESULTED IN THE FOLLOWING:

YEAS: _____

NAYS: _____

ABSTAIN: _____

ABSENT: _____

THIS ORDINANCE WAS DECLARED DULY ADOPTED AT A REGULAR MEETING OF THE PARISH COUNCIL ON THE 1 DAY OF SEPTEMBER, 2011; AND BECOMES ORDINANCE COUNCIL SERIES NO _____.

MARTIN W. GOULD, JR., COUNCIL CHAIRMAN

ATTEST:

THERESA L. FORD, COUNCIL CLERK

KEVIN DAVIS, PARISH PRESIDENT

Published Introduction: AUGUST 18, 2011

Published Adoption: _____, 2011

Delivered to Parish President: _____, 2011 at _____

Returned to Council Clerk: _____, 2011 at _____

EXHIBIT "A"

ZC11-06-057

ALL THAT CERTAIN LOT OR PARCEL OF LAND, together with all the buildings and improvements thereon, and all the rights, ways, means, privileges, servitudes, appurtenances and advantages thereunto belonging or in anywise appertaining, situated in St. Tammany Parish, Louisiana, and being more fully described as follows, to-wit:

Commence at the Section corner common to Sections 26, 27, 34 and 35, Township 8 South, Range 14 East and measure North 00 degrees 18 minutes East a distance of 1,045.0 feet to the POINT OF BEGINNING.

From the POINT OF BEGINNING run North 00 degrees 55 minutes 16 seconds East a distance of 300.0 feet; thence South 89 degrees 30 minutes 47 seconds East a distance of 1,082.62 feet; thence South 19 degrees 55 minutes 17 seconds West a distance of 317.30 feet; thence North 89 degrees 33 minutes 29 seconds West a distance of 979.32 feet to the POINT OF BEGINNING, and containing 7.091 acres of land, more or less.

CASE NO.: ZC11-06-057
PETITIONER: Reed Ingram
OWNER: CRHGZH, L.L.C.
REQUESTED CHANGE: From HC-3 (Highway Commercial District) to I-1 (Industrial District)
LOCATION: Parcel located on the southwest corner of US Highway 11 & Fricke Road; S26,T8S,R14E, Ward 8, District 14

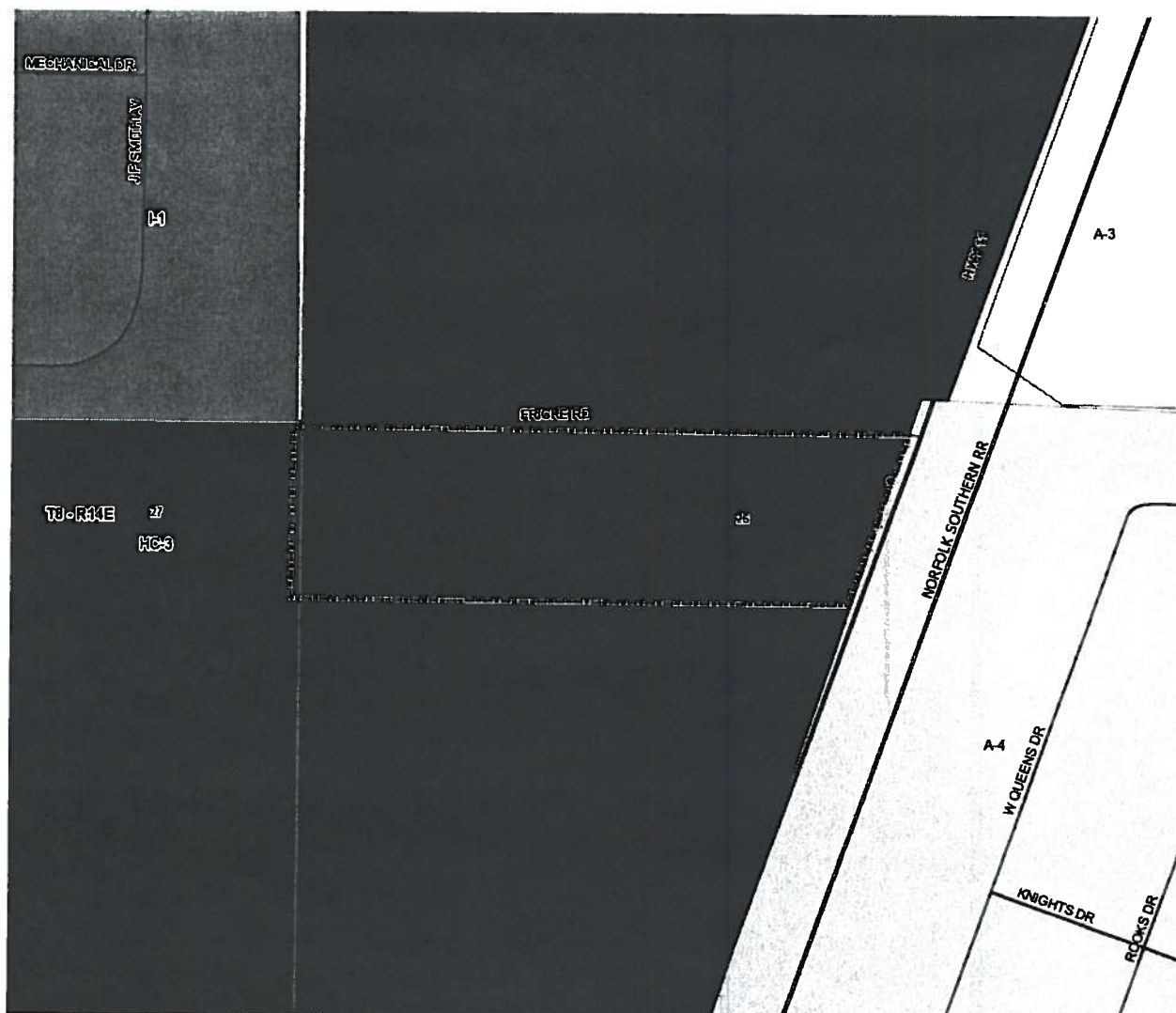

2C11-06-057

